

Situate on the East side of French Creek in Allegheny County. Containing 401<sup>ac</sup> & 150<sup>ac</sup> and allowed of Six per cent for Roads &c. Surveyed the 14<sup>th</sup> day of June 1794 In pursuance of a Warrant, dated the 10<sup>th</sup> day of April 1793.

To  
 Daniel Brodhead Esq.  
 Surveyor General

Am. Power D. S.

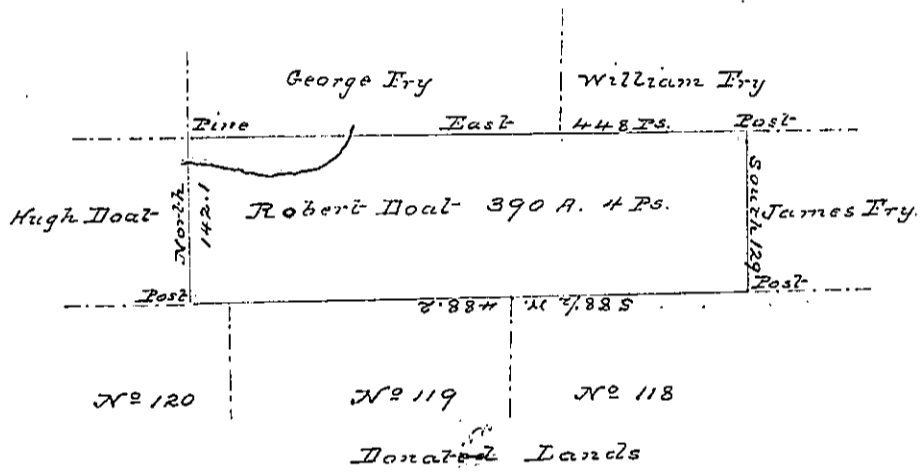

Situate on the waters of Little Sugar Creek in Allegheny County, Containing 390 acres & perches and allowed of Six per cent for Roads &c. Re-surveyed the 25<sup>th</sup> May 1798. In pursuance of a Warrant granted to Robert Doal dated the 10<sup>th</sup> April 1793, and an Order of Re-survey from the Board of Property of Pennsylvania date the 20<sup>th</sup> April 1798

To  
 Daniel Brodhead Esquire  
 Surveyor General

John Power D. S.

IN TESTIMONY that the above is a copy of the original remaining on file in the Department of Internal Affairs of Pennsylvania, made conformably to an Act of Assembly approved the 16th day of February, 1833, I have hereunto set my Hand and caused the Seal of said Department to be affixed at Harrisburg, this Twenty eighth day of November 1887.

*John J. Stewart*  
 Secretary of Internal Affairs